

MEDIUM BRIGHT 24V 8MM



Constant Current , Max Run 66 Ft.

NEW



ITEM NO.	Color Temp
WS 0827	2700K
WS 0830	3000K
WS 0855	5500K

Description	Details
Package Length	66 Feet Per Reel
Cut Internals	1.9 ” Per cut
Voltage	24V DC
Max Run	66 Feet
Rating	IP 20
Watts Per Ft.	2.29 W/ Ft.
Efficiency	91 Lm./ W
Lumens Per Ft.	202 / 205 / 208
CRI	>90
Warranty	5 Years

SUPER BRIGHT 24V 10MM



Max Run 32.8 Ft.

NEW



ITEM NO.	Color Temp
WS 1027	2700K
WS 1030	3000K
WS 1055	5500K

Description	Details
Package Lengths	100 Feet Per Roll
Cut Internals	1.9 " per cut
Voltage	24V DC
Max Run	32.8 Feet
Rating	IP 20
Watts Per Foot	4.42 W/FT.
Efficiency	140 LM./W
Lumens	561/596/619
CRI	>90
Warranty	5 Years

MEDIUM BRIGHT 12V 8MM

Random Cutting, Max Run 16.4 Ft.

NEW



Item No.	Color Temp
WS 0085	2700K
WS 0086	3000K
WS 0087	5500K

Description	Details
Package Length	100 Feet Per Roll
Cut Internal	Anywhere
Voltage	12V DC
Max Run	16.4 Feet
Rating	IP 20
Watts Per Ft.	2.44 W/ Ft.
Efficiency	91 Lm. / W
Lumens Per Ft.	202/ 205/ 208
CRI	>85
Warranty	2 Years

12V - COB STRIP LIGHT

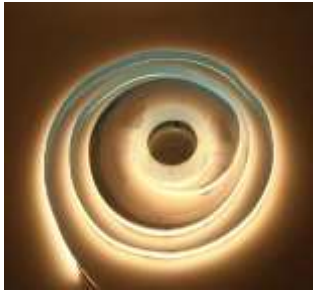

3000K



6000K

Item # WS0083

- ✓ 16.4feet / Roll
- ✓ 12 v Dc
- ✓ PCB (MM)_8MM
- ✓ 336LED/ M
- ✓ 16W / M
- ✓ 1400LM / M

Item # WS0084

- ✓ 16.4feet / Roll
- ✓ 12 v Dc
- ✓ PCB (MM)_8MM
- ✓ 336LED/ M
- ✓ 16W / M
- ✓ 1400LM / M



Item # WS 9083

Middle Connect

ACCESSORIES FOR COB 12/24V

NEW

L/T CONNCTOR FOR 8MM & 10MM

Item No. WS9086



For 8 mm only



Item No. WS9106



For 10 mm only

MIDDLE CONNETOR FOR 8MM & 10MM COB 12V/24V

Item No. WS9083



Item No. WS9103



6" POWER CONNETOR FOR 8MM & 10mm COB 12V/24V

Item No. WS9084



Item No. WS9104



6" JUMP CONNETOR FOR 8 MM & 10MM COB 12V/24V

Item No. WS9085



Item No. WS9105



12V H (High Level)- Single Color Strip



APPROVED



2700K

3000K

3500K

4500K

5500K

Item # WS0024

WS0020

WS0021

WS0022

WS0023

*** 12V * 36W/Roll * waterproof * 4 pin Male/Female ***

Parts Included



- **15" connector 1pc**
- **20 pcs of clip**
- **2 pcs of black rubber cover**

ACCESSORIES FOR H-SINGLE COLOR

Directly Connect These Accessories To The Rolls

Item # WS0121

12" Wire Connector 4 Pin



❖ Use for single & RGB

Item # WS0120

Cross Connector 4 Pin



❖ Use for single & RGB

Item # WS0096

N4 T Connector



❖ Use for single & RGB

Item # WS0097

N4 L Connector



❖ Use for single & RGB

Item # WS0098

N4 Cross Connector



❖ Use for single & RGB

Item # WS0099

N4 Middle Connector



❖ Use for single & RGB

Accessories To Use After Custom Cuts Are Made

Item # WS0124

M4-Connect Box



❖ Middle Connector
❖ 4 clip

Item # WS0125

H4-Connector 6"



❖ Head Connector
❖ 4 clip & 4 wire

Item # WS0126

M4-Connector 6"



❖ 4 clip

Item # WS 0129

L Connector

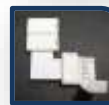

Item # WS 0130

T Connector



Item # WS 0131

Cross Connector

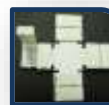

Other Accessories



Item # WS0127 **15" Connector**

❖ DC & 4Pin Head



Item # WS0128 **T Connector 4 Pin**

❖ DC & 4Pin Head (Male & Female)



Item # WS0133 **4 Wire Line**

Sell by feet

12V H (HIGH LEVEL) – RGB STRIP LIGHT



NON-WATERPROOF

Item # WS0010

- **4 Pin Male / Female**
- **4 Pin / 1 Meter & 4 Pin / 5 Meter**
- **Use 150pcs 5050LED Chip / Roll**
- **16.40 ft. / Roll, DC 12v, 36 W / Roll**
- **Best Quality Use: LED Chips, Circuit Board & Components**

WATERPROOF

Item # WS0011

Parts Included



- **25 pcs of clip**
- **2 pcs of black rubber cover**
- **5 pcs of pin**

CONTROLLERS & AMPLIFIERS For 12V RGB

Item # WS0169

44 Keys New Plastic GRB IR Controller



- ✓Power: 72 W
- ✓Input: 12 V Output: 6 A

Item # WS0165

New Mini RGB RF Controller



- ✓Power: 144 W (Can control 1 Roll only !)
- ✓Input: 5-24V / Output:12 V
- ✓22 Dynamic mode, 20 Static color

Item # WS0161

New Aluminum RGB RF Controller



- ✓Power: 144 W
- ✓Input: 12-24V / Output: Current:12V
- ✓With Dimmer Function

Item # WS0171 *Aluminum Amplifier*



- ✓Power: 144 W
- ✓Input / Output: 12V

Item # WS0170 *Mini Amplifier*



- ✓Power: 144 W(1 Roll only)
- ✓Input / Output: 5-24V

CONTROLLERS FOR 12V RGB

12V RGB 360W RF CONTROLLER

Item # WS 0166



- **Supply Voltage:** DC5V/12V/24V
- **Remote Control Distance:** 20m
- **Power Output:** 5V/120W, 12V/360W, 24V/576W

12V RGB 360W RF CONTROLLER

Item # WC 0001 w/ Touch Remote

Item # WC 0002 w/o Remote



Supply voltage	DC5V, 12V~24V optional (specify the required voltage on orders)
Output current	<8A(each channel)
Output power	5V:<120W, 12V:<360W, 24V:<576W

Wire Instruction for Job for Both Controller

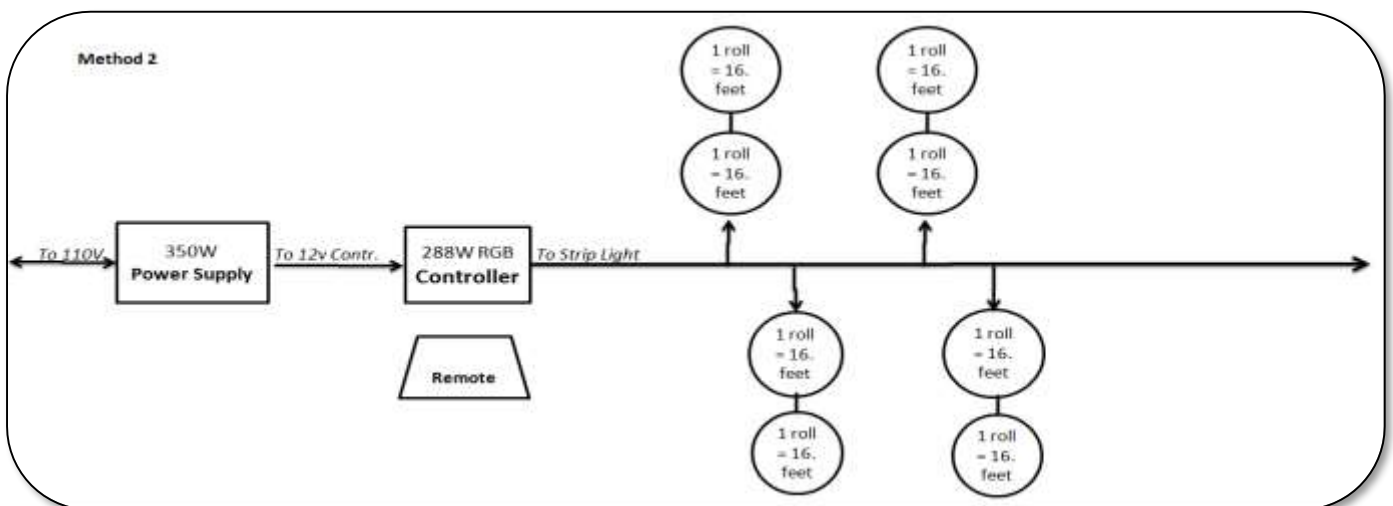

ACCESSORIES FOR RGB STRIP

Directly Connect These Accessories To The Rolls

Item # WS0096

N4 T Connector



❖ Use for single & RGB

Item # WS0097

N4 L Connector



❖ Use for single & RGB

Item # WS0098

N4 Cross Connector



❖ Use for single & RGB

Item # WS0099

N4 Middle Connector



❖ Use for single & RGB

Item # WS0120

Cross Connector 4 Pin



❖ Use for single & RGB

Item # WS0121

12" Wire Connector 4 Pin



❖ Use for single & RGB

Item # WS0122

12" Cable Connector 4 Pin



❖ Male & Female
❖ Use for RGB strip

Item # WS0123

24" Cable Connector 4 Pin

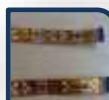

❖ Male & Female
❖ Use for RGB strip

Accessories To Use After Custom Cuts Are Made

Item # WS0124

M4-Connect Box



❖ Middle Connector
❖ 4 clip

Item # WS0126

M4-Connector 6"

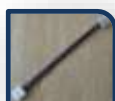

❖ 4 clip

Item # WS 0130

T Connector



Item # WS0125

H4-Connector 6"



❖ Head Connector
❖ 4 clip & 4 wire

Item # WS 0129

L Connector

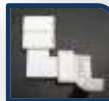

Item # WS 0131

Cross Connector



Other Accessories

Item # WS0133

4 Wire Line



Sell by feet
❖ 1 Meter long
❖ Clear Plastic

12V M (MIDDLE LEVEL) – RGB STRIP LIGHT



M-GRB **300pcs** 5050chip
4 Pin (Male & Female)

Waterproof

Item # WS0042

✓ **16.4feet / Roll**

✓ **12 v Dc**

✓ **72 w / Roll**

✓ **4Pin(male,female)/**

Roll

12V M (MIDDLE LEVEL) - Single Color 300 /Roll



- 300 pcs 5050 LED chip/roll
- 12V
- 16.4Ft./Roll
- DC head male/female
- 48 W /Roll

<p><u>3000K</u> <i>use 300 pcs 5050 LED chip/ roll</i></p>	<p>None Waterproof Item# WS 0043</p>	<p>Waterproof Item# WS 0043W</p>
<p><u>5500K</u> <i>use 300 pcs 5050 LED chip/ roll</i></p>	<p>None Waterproof Item# WS 0044</p>	
<p><u>Green</u> <i>use 300 pcs 5050 LED chip/ roll</i></p>		<p>Waterproof Item# WS 0065</p>
<p><u>Blue</u> <i>use 300 pcs 5050 LED chip/ roll</i></p>		<p>Waterproof Item# WS 0066</p>
<p><u>Red</u> <i>use 300 pcs 5050 LED chip/ roll</i></p>		<p>Waterproof Item# WS 0067</p>
<p><u>Yellow</u> <i>use 300 pcs 5050 LED chip/ roll</i></p>		<p>Non Waterproof Item# WS 0068</p>

Item # WS0116
N2 T Connector



Item # WS0117
N2 L Connector



Item # WS0118
N2 Cross Connector



Item # WS0109
N2 Connector 6"



Item # WS0119
N2 Connect Box



Accessories' details on P. 11

ACCESSORIES FOR M-SINGLE COLOR

Use for 600 pcs LED chip

Use for 300 pcs LED chip

Item # WS0114 **3DC Power Feet**



❖ Use for M-Single color strip lights

Item # WS0116 **N2 T Connector**



❖ Middle Connector
❖ 2 clip

Item # WS0115 **1DC Power Feet**



❖ Use for M-Single color strip lights

Item # WS0117 **N2 L Connector**



❖ Middle Connector
❖ 2 clip

Item # WS0110 **M2 Connect Box**



❖ Middle Connector
❖ 2 clip

Item # WS0118 **N2 Cross Connector**



❖ Middle Connector
❖ 2 clip

Item # WS0112 **H2 Connector 6"**



❖ With DC Head
❖ 2 clip & 2 wire

Item # WS0119 **N2 Connect Box**



❖ Middle Connector
❖ 2 clip

Item # WS0111 **M2 connector 6"**



❖ 2 clip

Item # WS0109 **N2 Connector w/ DC**



❖ With DC Head
❖ 2 clip

Item # WS0108 **N2 Connector 6"**



❖ 2 clip

DIMMER FOR SINGLE COLOR

Item # WS0182 *Mini Dimmer w/ Remote*



- Power: 144W
- Input: DC5-24V
- Output: 12A

Item # WS0180 *Dimmer Set*



- Power: 96W
- Input: DC12-24V
- Output: 8A

Item # WS0181 *Dimmer for Wall w/ Remote*



- Power: 72W
- Size:L3 3/8" x W3 3/8" x H1 5/8"
- Supply: DC12-24v, Current: 6A

H - CHASING STRIP LIGHT



Waterproof

Item # WS0002

- **114 Modes of Chasing Color Change**
- **Use 150pcs 5050LED Chip / Roll, 5 Pin Male/Female**
- **16.40 feet / Roll, DC 12v, 36 w / Roll**

Parts Included



- **25 pcs of clip**
- **2 pcs of pin**
- **2 pcs of black rubber cover**

H-CHASING ACCESSORIES

Item # WS0164

Chasing Controller



- ❖ Effect Mode= 114 modes of chasing color change
- ❖ Input/Output: DC12v only
- ❖ Current: <60MA
- ❖ Use for **High Level Chasing Strip**

Item # WS0100

T Connector 5 Pin



- ❖ Power Supply Connect
- ❖ Pin Connect
- ❖ Use for High Level Chasing

Item # WS0101

12" Wire Connector 5 Pin



- ❖ Use for High Level Chasing

Item # WS0102

Cross Connector 5 Pin



- ❖ Use for High Level Chasing

LED MODULE LIGHT, WATER PROOF , 12V



Item no: **WS 0070**
Color temp : **RGB** , High Brightness. 5050 LED Chips
Lumens : 120 Lumens / 3LED Chanel
Power : 0.72w/ 3LED Chanel
Length : 5 inch (Each Module :including wire)



Item no: **WS 0075**
Color temp : **6000-6500k**, High Brightness. 5730 LED Chips
Lumens : 165 Lumens / 3LED Chanel
Power : 1.44w / 3LED Chanel
Length : 5 inch (Each Module :including wire)



Item no: **WS 0071**
Color temp : **3000-3500k**, High Brightness. 5730 LED Chips
Lumens : 165 Lumens / 3LED Chanel
Power : 1.44w / 3LED Chanel
Length : 5 inch (Each Module :including wire)

Switchable & Dimmable driver

12v/24v



60W

Item # WP 0060



- Input: 120-277Vac 50/60 Hz
- Output: 12v5A-24v2.5A
- Prated: 60W Max
- Suitable for Dry, Damp and Wet Locations
- **25 pcs/CS**

Size:
6.3"x2.9"x1.3"

100W

Item # WP 0100



- Input: 120-277Vac 50/60Hz
- Output:12v 8.33A-24v 4.15a
- Prated: 100W Max
- Suitable for Dry, Damp and Wet Locations
- **20 pcs/CS**

Size:
6.5"x3.6"x1.5"

200W

Item # WP 0200



- Input:120-277Vac 50/60Hz
- Output:12v 16.5A-24v -8.26a
- Prated: 200W Max
- Suitable for Dry, Damp and Wet Locations
- **5 pcs/CS**

Size:
8.2"x3.7"x1.5"

300W

Item # WP 0300



- Input:120-277Vac 50/60Hz
- Output:12v 25A-24v -12.5A
- Prated: 300W Max
- Suitable for Dry, Damp and Wet Locations
- **5 pcs/CS**

Size:
10.2"x5.2"x1.7"

Dimmable Led Driver Output 12V



APPROVED

200W

Item # WS 146_UL200



- Input: AC100-240V
- Output: DC 12V
- 12V 5-in-1 Dimmable
- 0-100% Dimming
- Waterproof IP67

Size:
8"x3.5"x1.5"

LED DRIVER OUTPUT 24V



ITEM NO.	INPUT	OUTPUT	SIZE	IP RATING
WP 2601	AC 100-130V	DC24V Max 100W	5.8"x2"x1"	IP 20
WP 2602	AC 100-130V	DC24V Max 200W	8.6"x2"x1"	IP 20
WP 2603	AC 100-130V	DC24V Max 300W	9.5"x2"x1.2"	IP 20

TRANSFORMERS OUTPUT 12V

24W

Item # WS 0140



- Input: AC100-240V
- Output: DC 12V 2A

60W

Item # WS 0141



- Input: AC100-240V
- Output: DC 12V 5A

60W IP20

Item # WS 60WIP20



- Input: AC100-240V
- Output: DC 12V 5A

60W IP65

Item # WS 60WIP65



- Input: AC100-240V
- Output: DC 12V 5A

96W

Item # WS 0142



- Input: AC100-240V
- Output: DC 12V 8A

TRANSFORMERS OUTPUT 12V

150W IP20

Item # WS 150WIP20



- Input: AC 110-260V
- Output: DC 12V 12.5A

150W IP65

Item # WS 150WIP65



- Input: AC 110-260V
- Output: DC 12V 12.5A

250W IP20

Item # WS 0143



- Input: AC 110-260V
- Output: DC 12V 20A

250W IP65

Item # WS 250WIP65



- Input: AC 110-260V
- Output: DC 12V 20A

350W IP20

Item # WS 0144



- Input: AC 110-220V
- Output: DC 12V 29A

Instruction for 12v RGB Strip

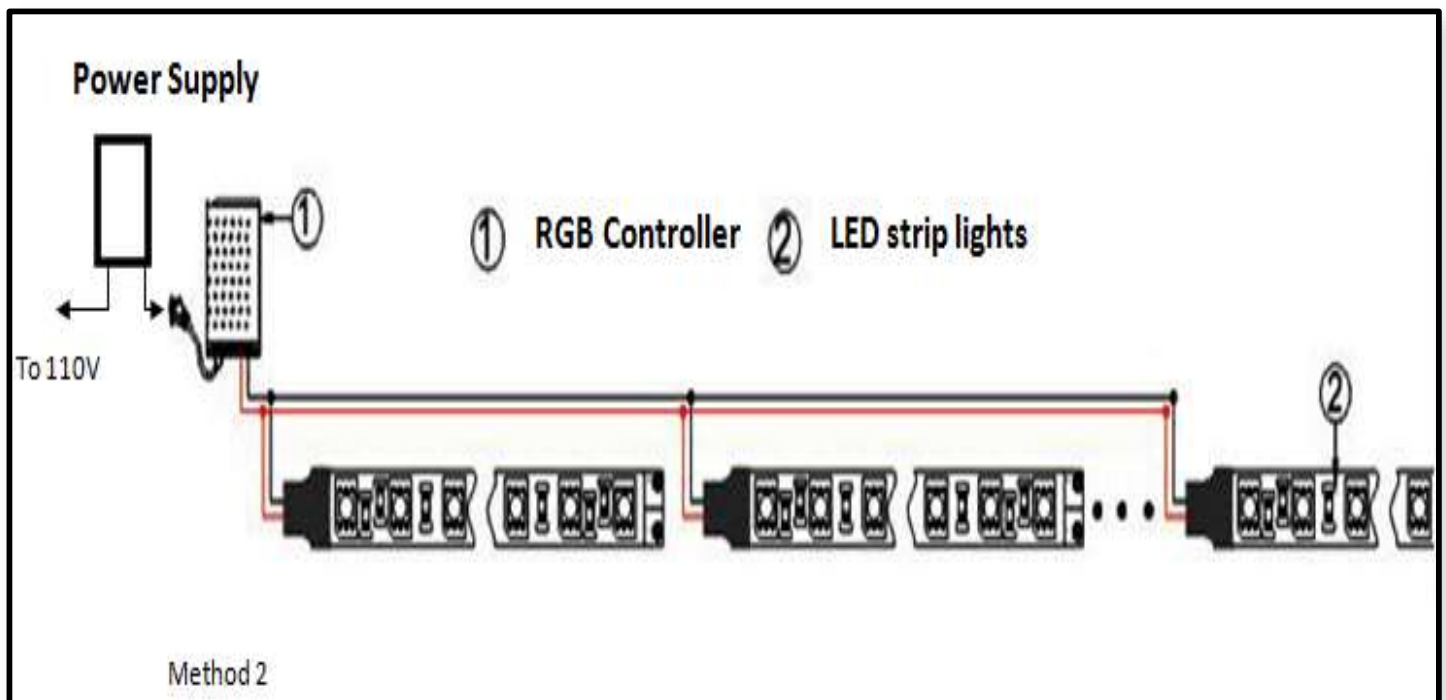
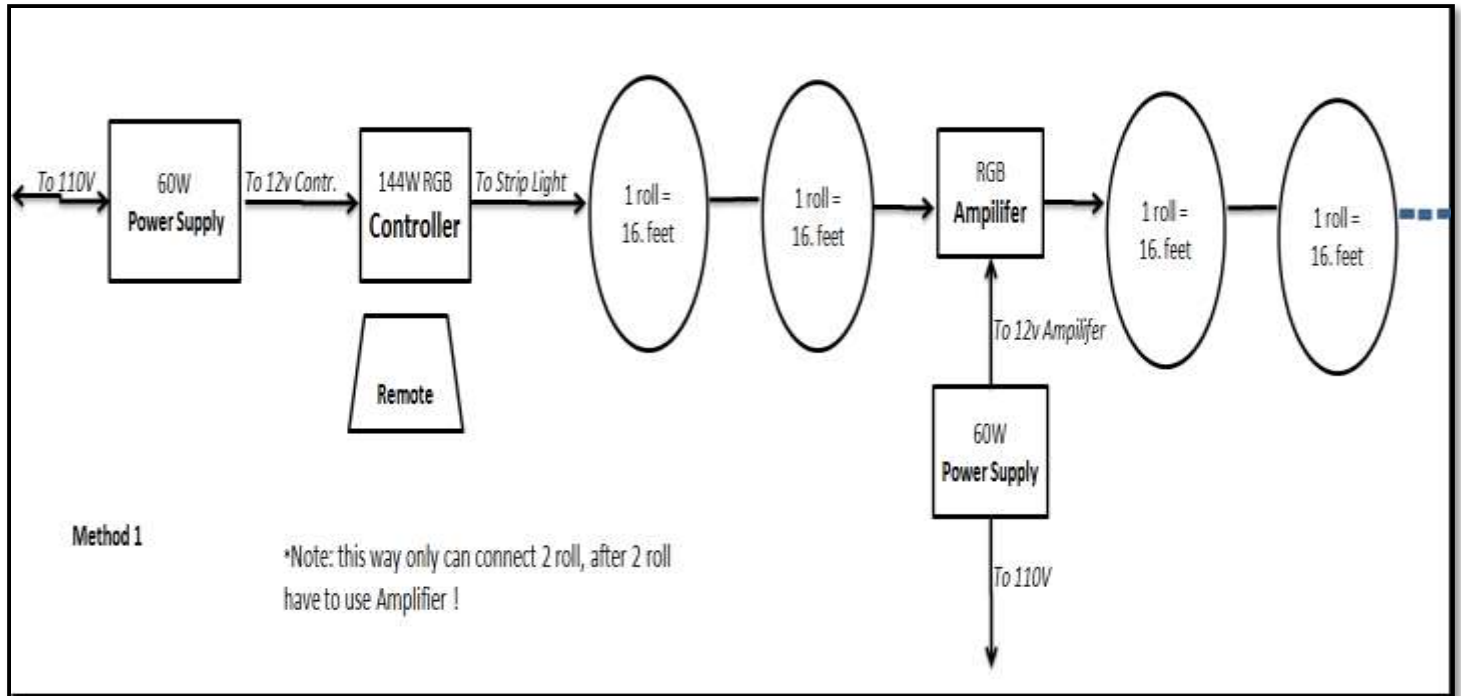

Wire Instruction for 12V Single Color Strip

